

SCS Marshfield - Phase I Address Plan

SCS MARSHFIELD – PHASE I

N. HUME AVE. MARSHFIELD, WISCONSIN 54449

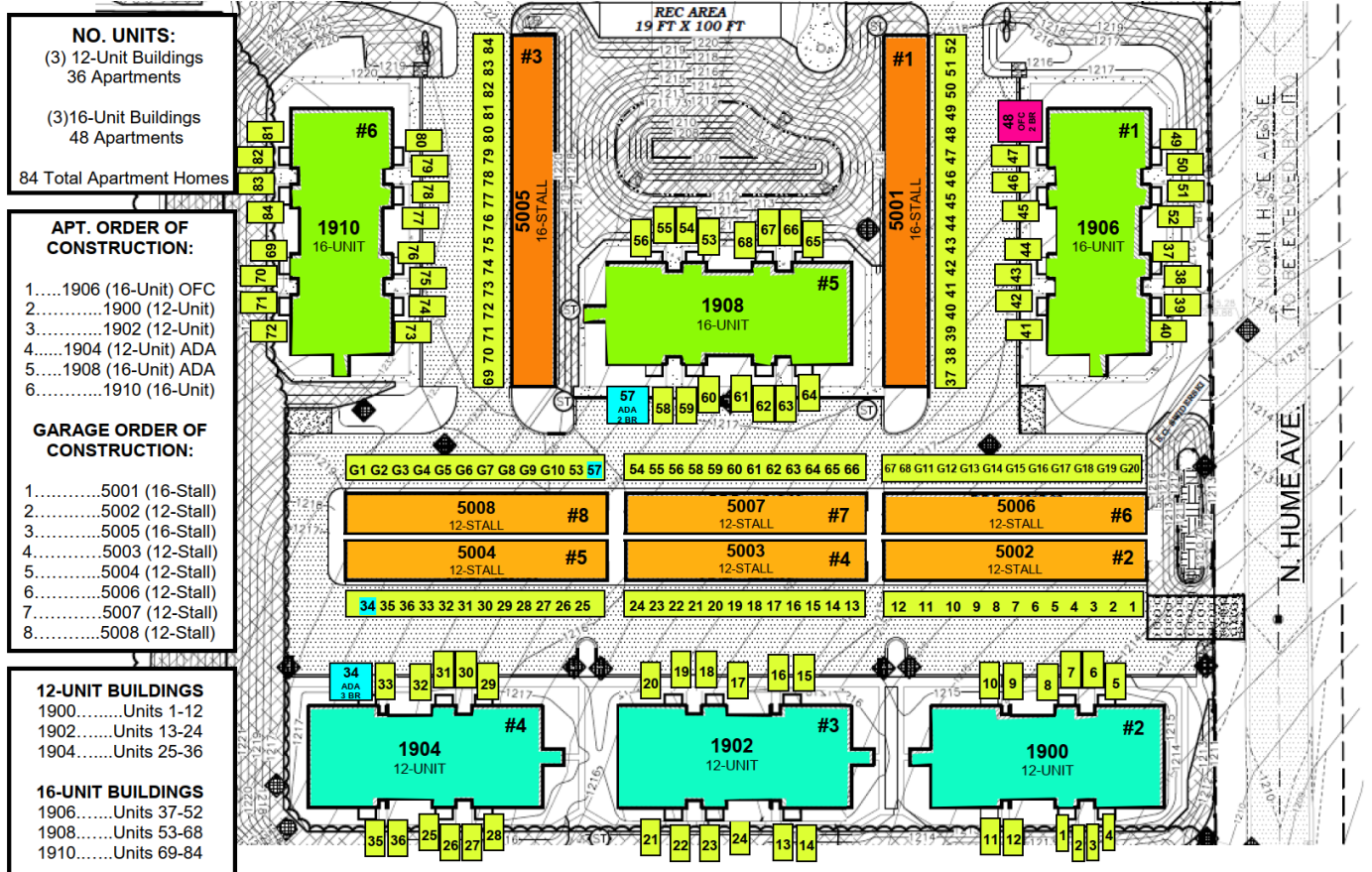

PROJECT MANAGER: Amber Keller | 715-846-0301 | akeller@scswiderski.com
PROJECT COORDINATOR: Becky Hensel | 715-693-7806 | becky@scswiderski.com
SITE SUPERINTENDENT: Randy Lilla | 715-340-3407 | randyllilla@scswiderski.com



SCS MARSHFIELD – PHASE II

N. HUME AVE. MARSHFIELD, WISCONSIN 54449

PROJECT MANAGER: Amber Keller | 715-846-0301 | akeller@scswiderski.com
PROJECT COORDINATOR: Becky Hensel | 715-693-7806 | becky@scswiderski.com

ADDRESS PLAN

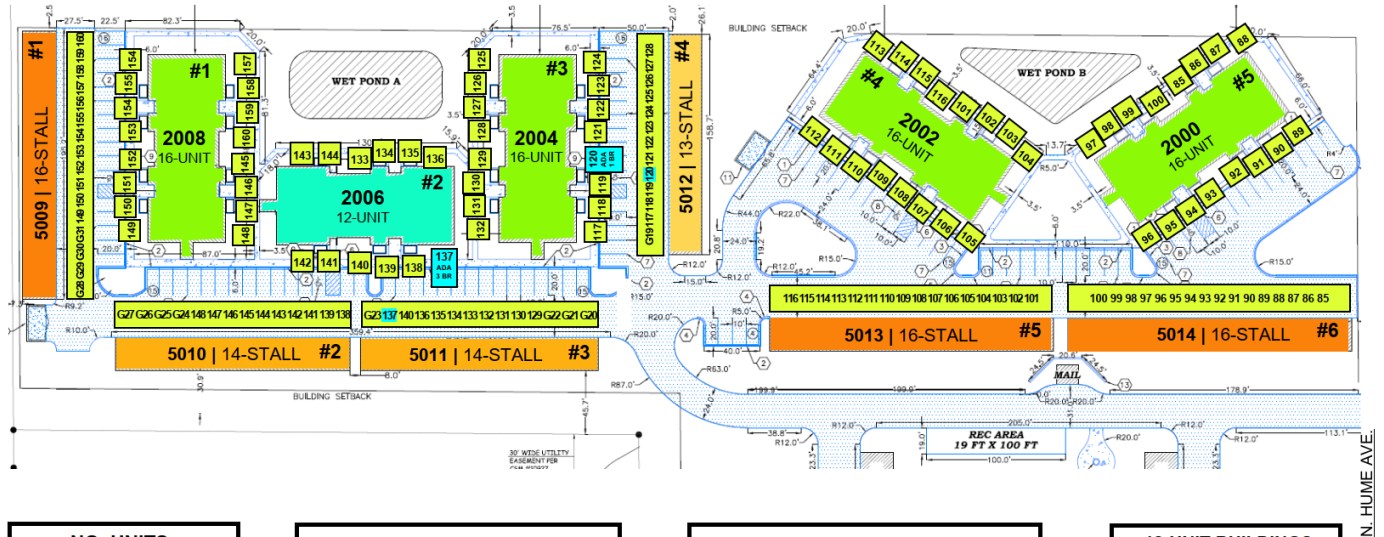

NO. UNITS:

- (1) 12-Unit Building
12 Apartments

- (4) 16-Unit Buildings
64 Apartments

76 Total Apartment Homes

APT. ORDER OF CONSTRUCTION:

- 1.....2008 (16-Unit)
- 2.....2006 (12-Unit) ADA #137
- 3.....2004 (16-Unit) ADA #120
- 4.....2002 (16-Unit)
- 5.....2000 (16-Unit)

GARAGE ORDER OF CONSTRUCTION:

- 1.....5009 (16-Stall)
- 2.....5010 (14-Stall)
- 3.....5011 (14-Stall) ADA #137
- 4.....5012 (13-Stall) ADA #120
- 5.....5013 (16-Stall)
- 6.....5014 (16-Stall)

12-UNIT BUILDINGS

2006.....Units 133 - 144

16-UNIT BUILDINGS

2000.....85-100
2002.....101-116
2004.....117-132
2008.....145-160

Revision #3

Created 8 June 2023 16:12:14

Updated 27 August 2024 15:28:14 by Dale Bergman