

# SCS Marshfield - HUME 1

## Address Plan

# SCS MARSHFIELD – PHASE I

N. HUME AVE. MARSHFIELD, WISCONSIN 54449

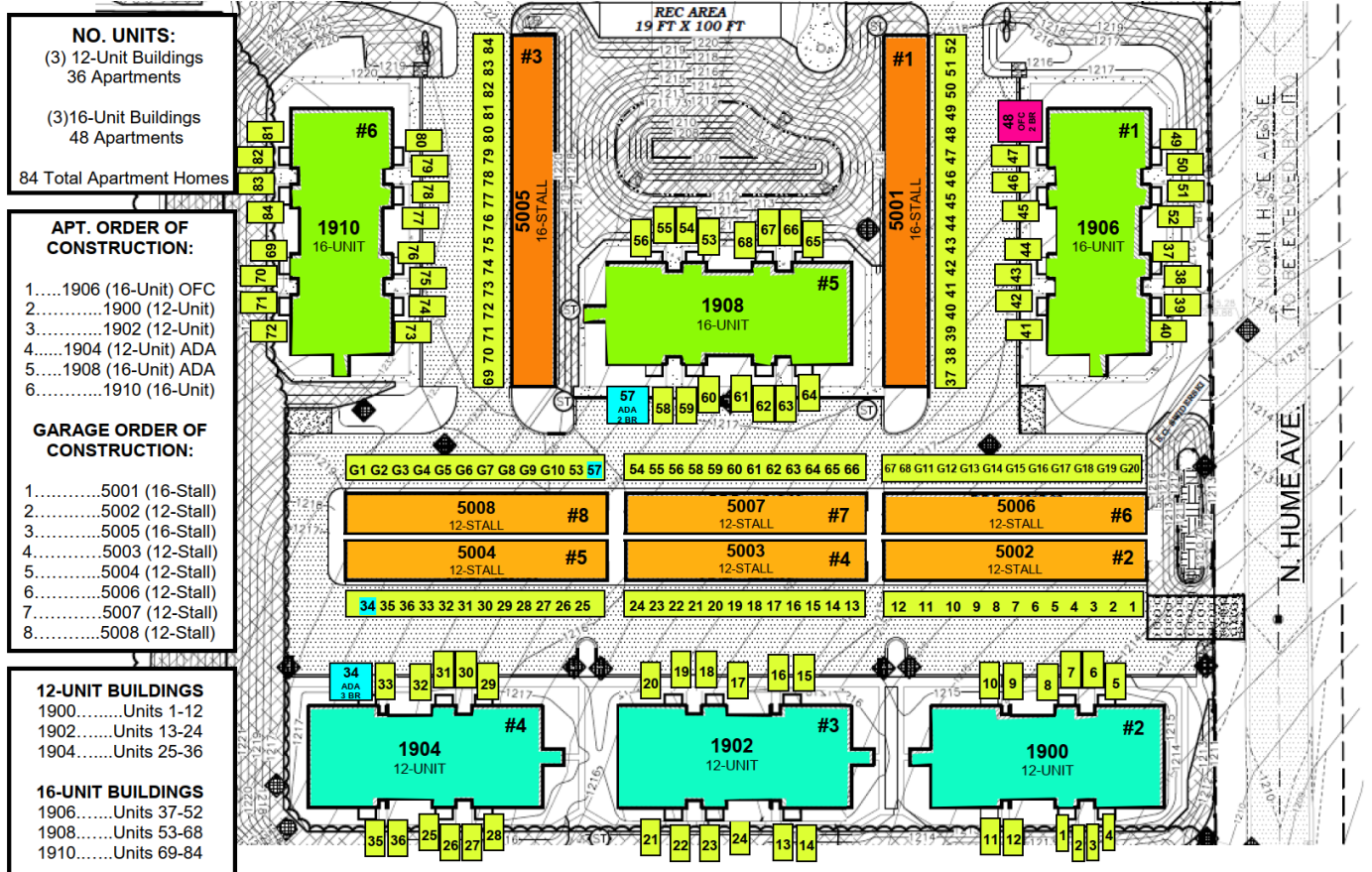

**PROJECT MANAGER:** Amber Keller | 715-846-0301 | [akeller@scswiderski.com](mailto:akeller@scswiderski.com)  
**PROJECT COORDINATOR:** Becky Hensel | 715-693-7806 | [becky@scswiderski.com](mailto:becky@scswiderski.com)  
**SITE SUPERINTENDENT:** Randy Lilla | 715-340-3407 | [randyllilla@scswiderski.com](mailto:randyllilla@scswiderski.com)



# SCS MARSHFIELD – PHASE II

N. HUME AVE. MARSHFIELD, WISCONSIN 54449

PROJECT MANAGER: Amber Keller | 715-846-0301 | akeller@scswiderski.com  
PROJECT COORDINATOR: Becky Hensel | 715-693-7806 | becky@scswiderski.com

## ADDRESS PLAN

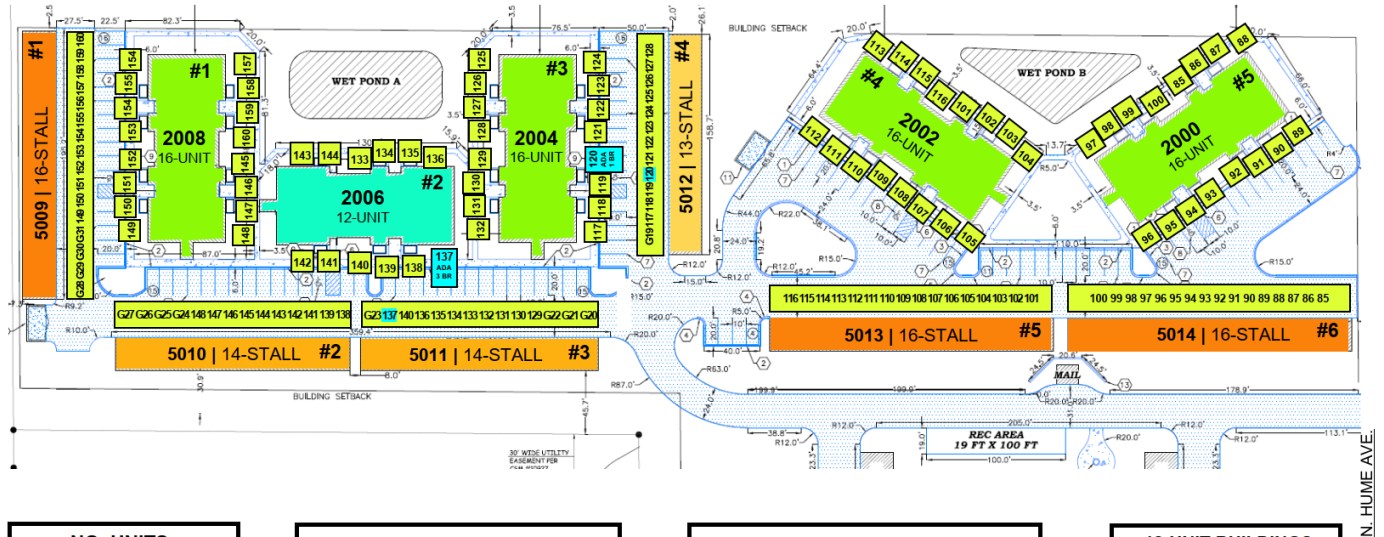

### NO. UNITS:

- (1) 12-Unit Building  
12 Apartments

- (4) 16-Unit Buildings  
64 Apartments

76 Total Apartment Homes

### APT. ORDER OF CONSTRUCTION:

- 1.....2008 (16-Unit)
- 2.....2006 (12-Unit) ADA #137
- 3.....2004 (16-Unit) ADA #120
- 4.....2002 (16-Unit)
- 5.....2000 (16-Unit)

### GARAGE ORDER OF CONSTRUCTION:

- 1.....5009 (16-Stall)
- 2.....5010 (14-Stall)
- 3.....5011 (14-Stall) ADA #137
- 4.....5012 (13-Stall) ADA #120
- 5.....5013 (16-Stall)
- 6.....5014 (16-Stall)

### 12-UNIT BUILDINGS

2006.....Units 133 - 144

### 16-UNIT BUILDINGS

2000.....85-100  
2002.....101-116  
2004.....117-132  
2008.....145-160

Revision #4

Created 8 June 2023 16:12:14

Updated 30 January 2025 17:09:38 by Dale Bergman